

# Mora Inxx A6 4-hole mixer

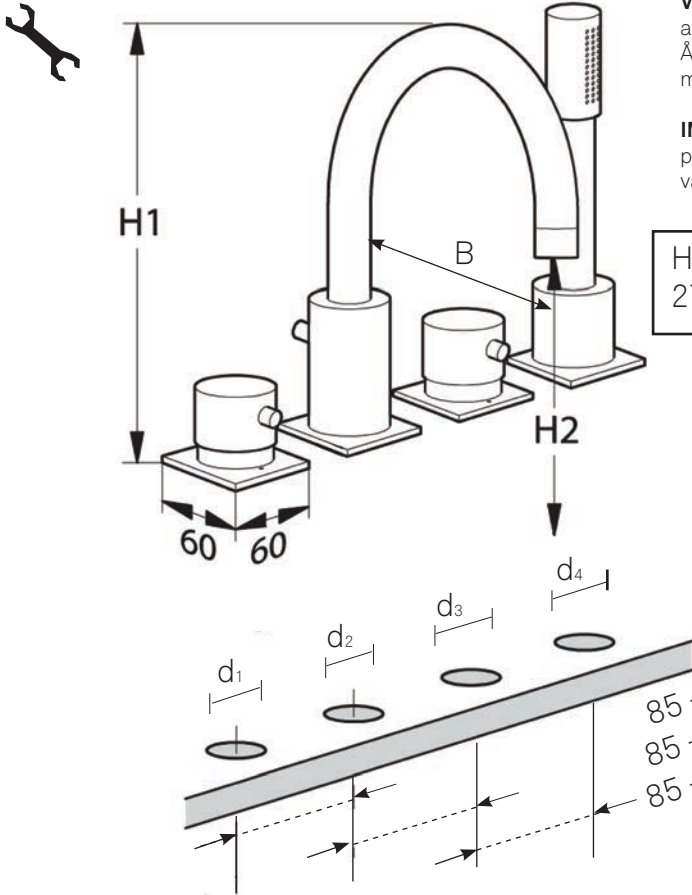

**VIKTIGT!** Monteringen av Mora Inxx 4-hålsblandare måste utföras med tanke på att kopplingsdetaljer alltid skall vara åtkomliga för eventuella framtida servicebehov. Åtkomlighet kan ordnas till exempel med hjälp av en så kallad inspektionslucka, eller motsvarande som ger tillgänglighet till blandaren och dess kopplingar.

**IMPORTANT!** It is recommended that before fitting the spabath-shower system provision is made to provide access for any later servicing which may be required on the valve or diverter. This may be done by means of a removable cover or inspection panel.

H1	H2	B
270mm	150mm	150mm

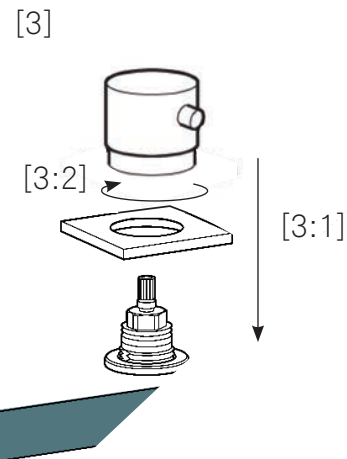
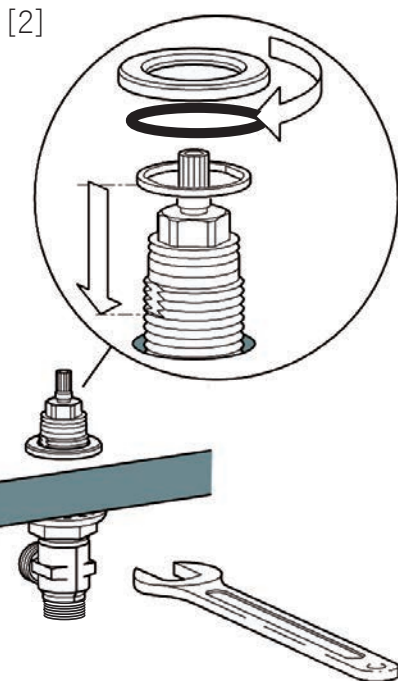
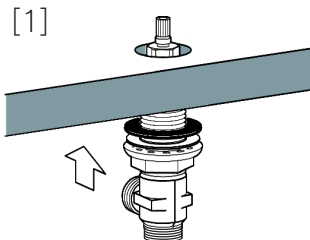
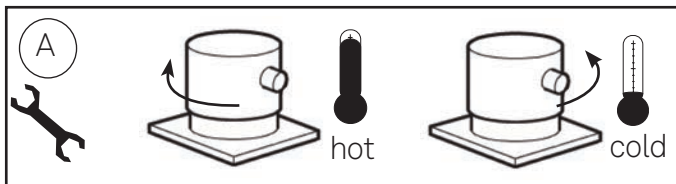
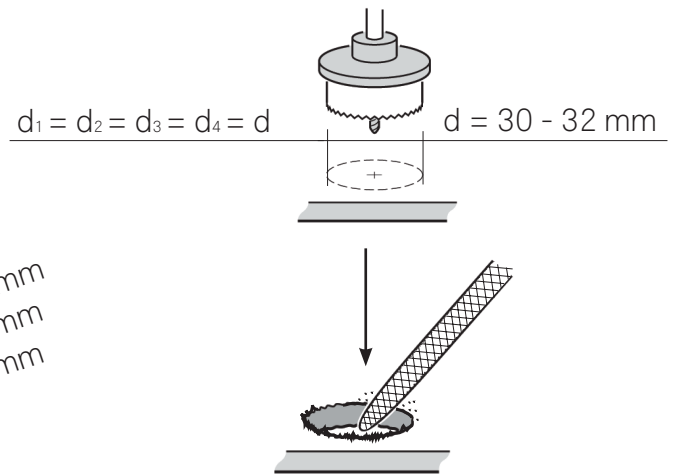

Mora Inxx A6

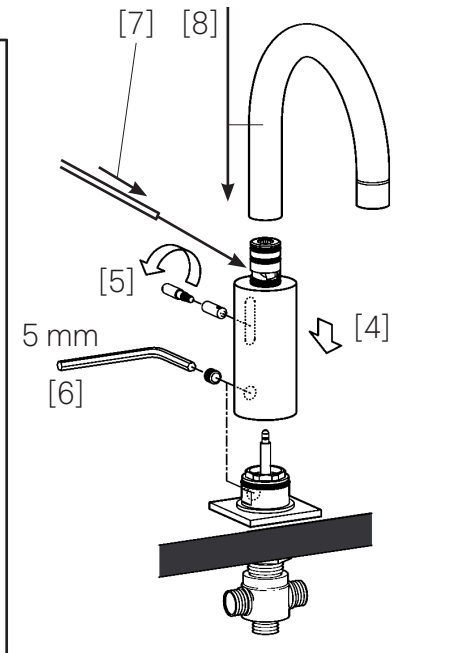
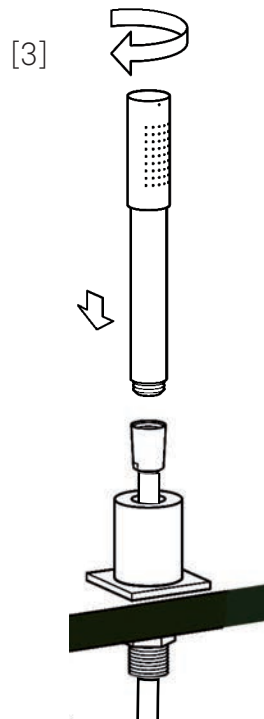
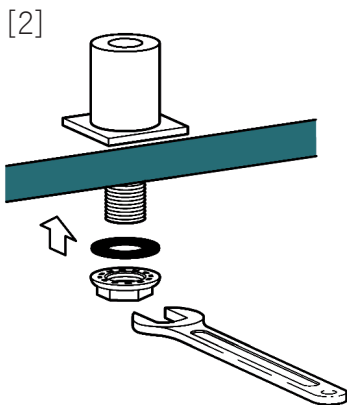
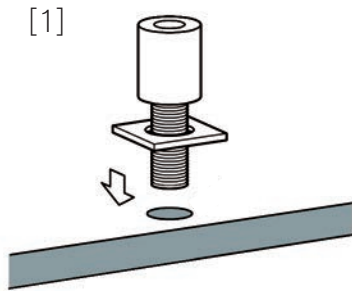
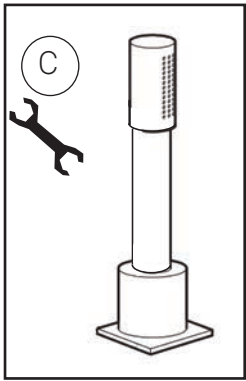
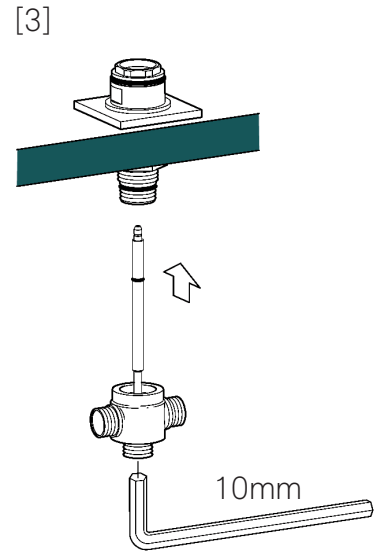
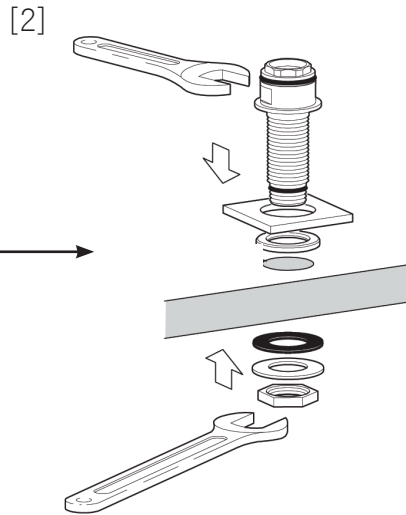
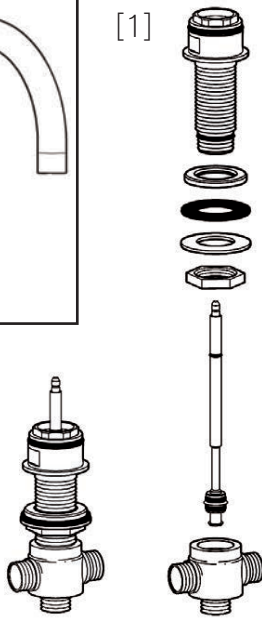
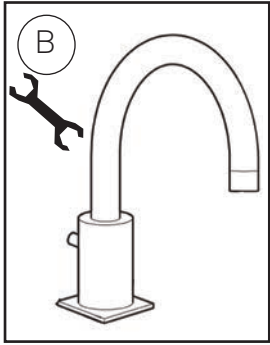

# Mora Inxx A6

D

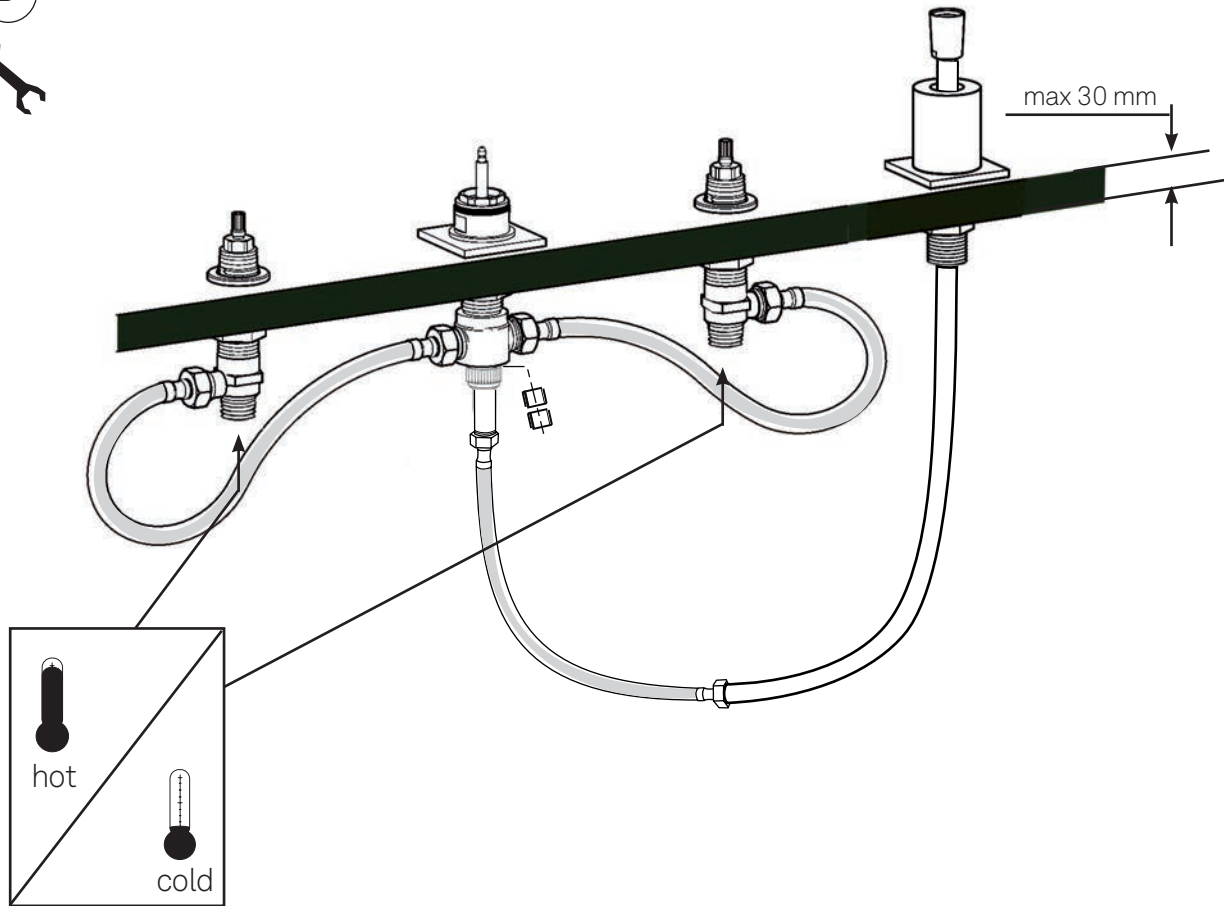

# Mora Inxx A6

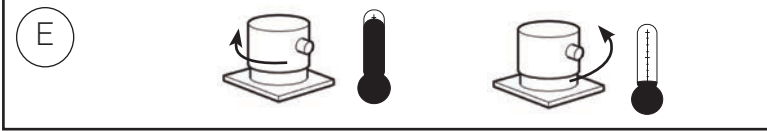

Ma-nr 708935

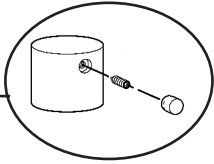

Ma-nr 708934

Ma-nr 708949

Ma-nr 708940

Ma-nr 708943

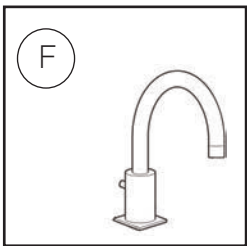
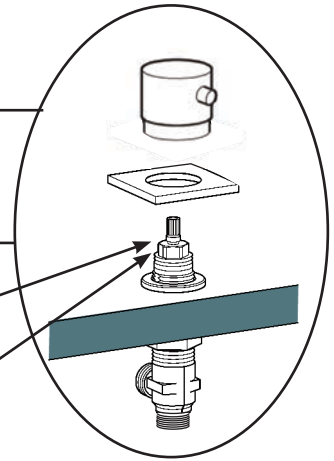

Ma-nr 708933

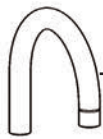

Ma-nr 409423

Ma-nr 708950

Ma-nr 708937

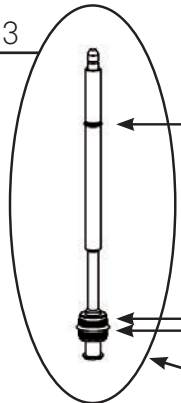
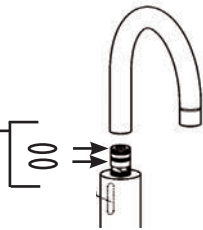

Ma-nr 708938

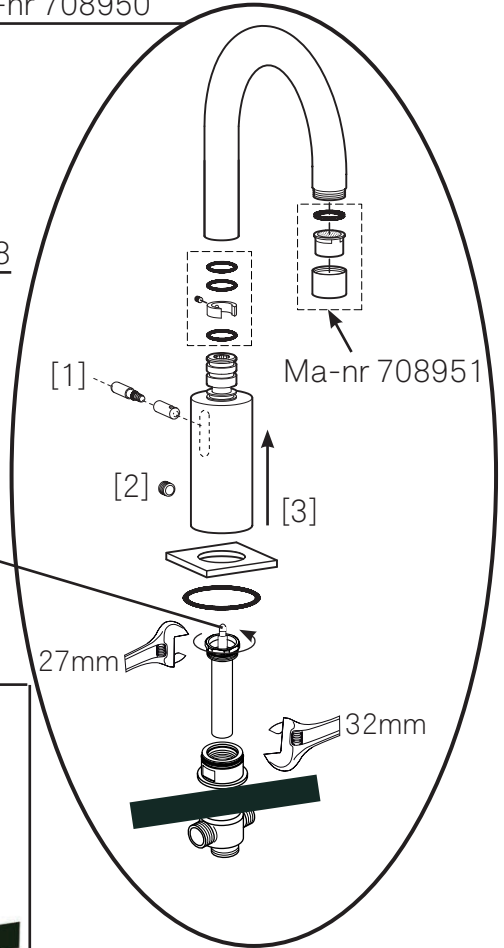

Ma-nr 708951

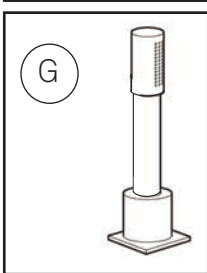

Ma-nr 708936

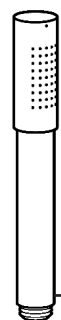

Ma-nr 139785

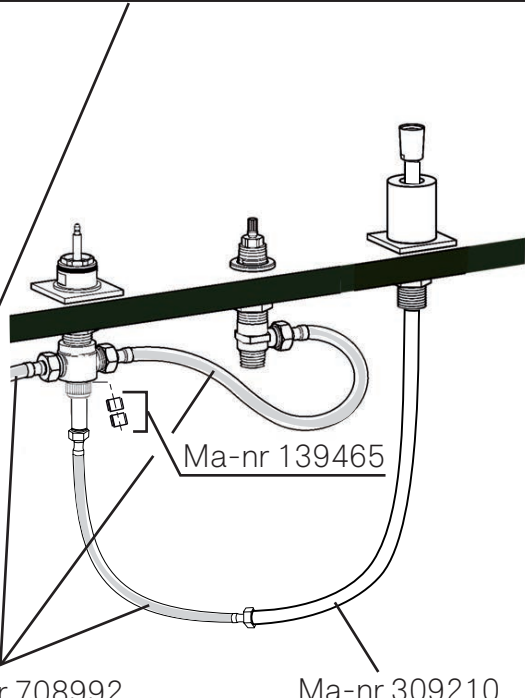
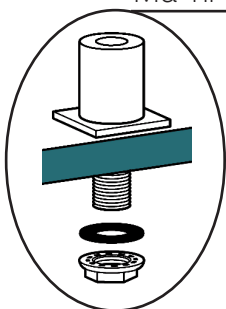

Ma-nr 139465

Ma-nr 708992

Ma-nr 309210